

Norms : EN354:2002 EN354:2010 EN358:1999 **References Numbers :** FA4010010 – FA4010015 – FA4010020 – FA4010310 FA4010315 – FA4010320 – FA4030015 – FA4030015A – FA4030210 – FA4030215 – FA4030315 – FA4030415 – FA4040015 – FA4050010 – FA4050015 – FA4050020 FA4050210 – FA4050215 – FA4050220 – FA4050310 – FA4050315 – FA4050320 – FA4060010 – FA4060015 – FA4090020 - FA4090120 – FA4090220 – FA4090320 - FA4090320A – FA4090340 – FA4090420 FA4090440 – FA4090520 – FA4090650 – FA4090720

Following the user instruction manual of the product and the inspection sheet, and without any specific tool or a particular measuring device. Observe and touch each component of the product in order to detect possible anomalies. If one or more checkpoints are defective, the product must be withdrawn from service and replaced by a compliant device.

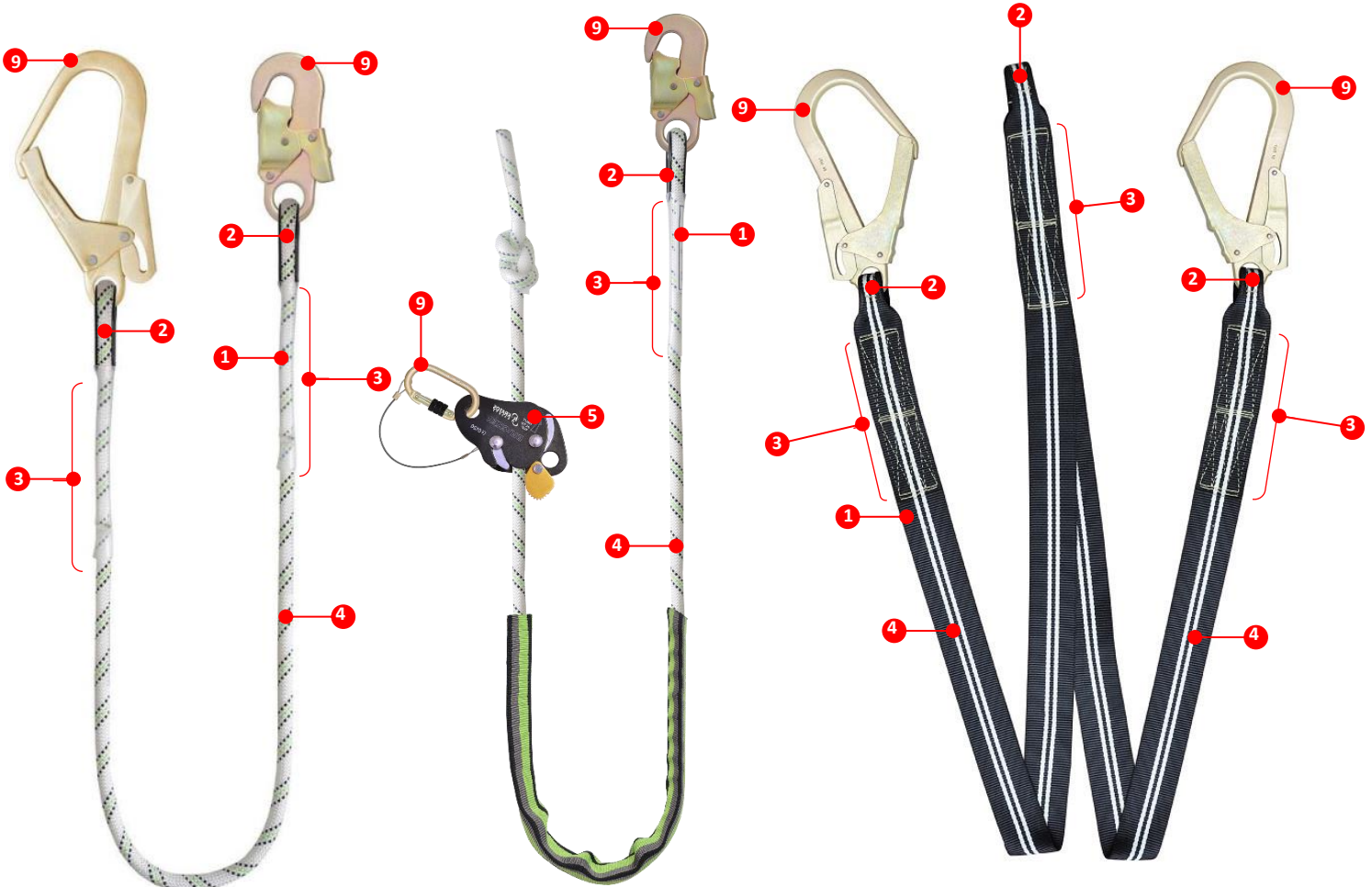
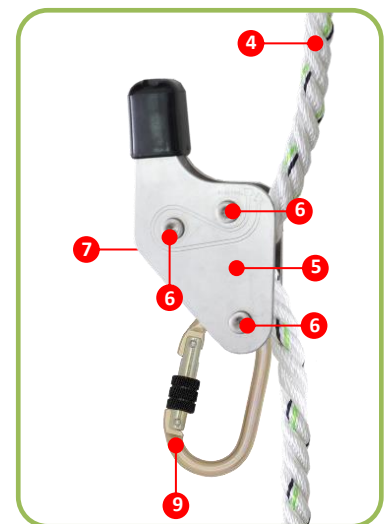
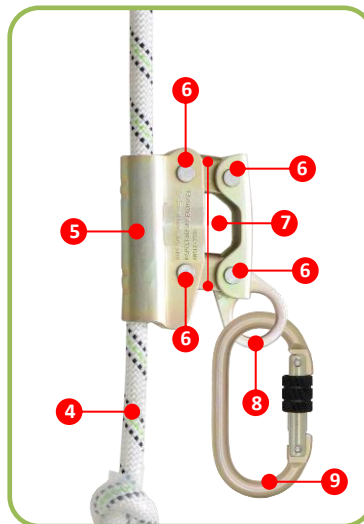

Checkpoints

Inspect the visual aspect of the product; the device must be checkable.

1 I.D label :

Make sure that the I.D label is present and readable.

2 Lanyards tips :

Check the conditions of lanyards tips, no defects such as wear, cuts, burns or deformations must be present.

3 Lanyard's stitchings / Splices :

Check the condition of the stitchings and the splices at each end of the webbing, kernmantle or twisted rope, no defects such as wear, cuts, burns, deformations must be present. Check that the protective sleeves are present on the splices or on the stitchings (only the kernmantle and the twisted ropes are protected at each end by heatshrink protection sleeves.

4 Webbing / Kernmantle / Twisted lanyard:

Check the condition of the webbing / kernmantle rope / twisted rope on it's entire length, no defects such as wear, cuts, burns, deformations must be present. For elastic webbing lanyards, check that the elastic is still operating.

5 Length adjuster (according to the model) :

Check the condition of the length adjuster, it should not be misshapen, nor cut, wear, nor oxidated. Verify that the lanyard is locked when the length adjuster is in locking position

Specific Model : FA4090650 : Please refer to Guided Type fall arrester FA2010300A inspection guide.

6 Length adjuster assembly axes (according to the model) :

Verify the condition of the length adjuster assembly axes, no distortion, cut, wear, oxidation must be present.

7 Cams tensioner (according to the model) :

Check the condition of the cams tensioner, no distortion, cut, wear, oxidation must be present.

8 Anchorage ring (according to the model) :

Verify the condition of the anchorage ring, it should not be misshapen, oxidized, cut or worn.

9 Connectors (according to the model) :

Please refer to connectors's inspection guide

Overall Condition : *Evaluate the overall condition of the product according of the above checkpoints, and the visual aspect of the product*